

Variolink Esthetic® LC

Eingliederung von Veneers (Glaskeramik, Composite)

Einprobe

Variolink Esthetic Try-In

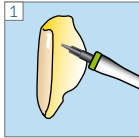

Auftragen der Try-In Paste

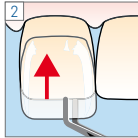

Einprobe der Restauration

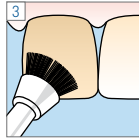

Reinigung nach der Einprobe

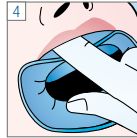

Trockenlegung

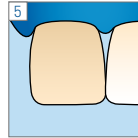

Restauration

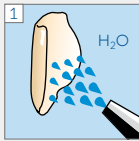

H₂O

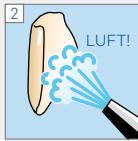

LUFT!

Vorbehandlung von Keramik-restaurationen:

Gemäss Herstellerangaben
 Z.B. IPS Empress: 60 s ätzen
 IPS e.max CAD/Press: 20 s ätzen
 mit IPS Ceramic Ätzel (Flusssäure).
 Sicherheitshinweise beachten.

Vorbehandlung von Composite-Restaurationen:

Gemäss Herstellerangaben
 Z.B. SR Nexco, 2 bar, Al₂O₃, 100 µm
 oder mit Finierdiamanten aufrauen.

Monobond Plus

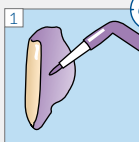

60 s

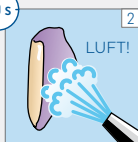

LUFT!

Präparation

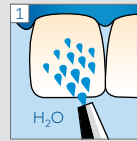

H₂O



LUFT!

Total Etch:

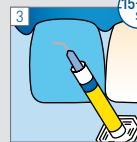

15-30 s

optional

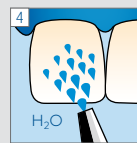

H₂O

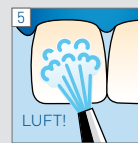

LUFT!

Adhese Universal

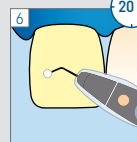

20 s

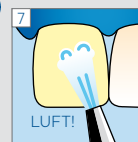

LUFT!

Pfützenbildung vermeiden

Bluephase G4



10 s

Befestigung

Variolink Esthetic LC

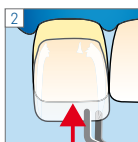
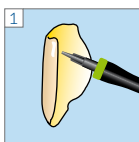

Bluephase G4



2 s

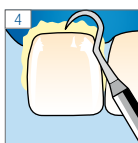

Restauration bis zum Ende der abschliessenden Polymerisation fixieren

Liquid Strip

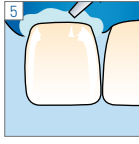
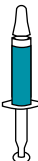

10 s

Polieren

Fluor Protector S

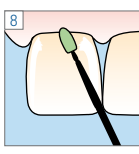

8



Hersteller
 Ivoclar Vivadent AG
 Bänderstrasse 2
 9494 Schaan/Liechtenstein
 www.ivoclar.com

CE 0123



See Instructions

Erstellungsdatum:
 2022-08-23
 666331/DE/Rev. 1



mehr Informationen unter
www.cementation-navigation.com

ivoclar

Variolink Esthetic® LC

Eingliederung von Inlays (Stärke < 2 mm) (Glaskeramik, Composite)

Einprobe

Variolink Esthetic Try-In

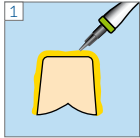

Auftragen der Try-In Paste

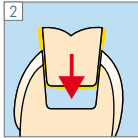

Einprobe der Restauration

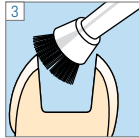

Reinigung nach der Einprobe

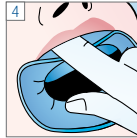

Trockenlegung

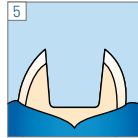

Restauration

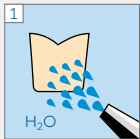

H₂O



LUFT!

Vorbehandlung von Keramik-restaurationen:

Gemäss Herstellerangaben
 Z.B. IPS Empress: 60 s ätzen
 IPS e.max CAD/Press: 20 s ätzen
 mit IPS Ceramic Ätzel (Flusssäure).
 Sicherheitshinweise beachten.

Vorbehandlung von Composite-Restaurationen:

Gemäss Herstellerangaben
 Z.B. SR Nexco, 2 bar, Al₂O₃, 100 µm
 oder mit Finierdiamanten aufrauen.

Monobond Plus

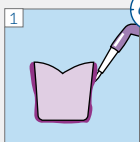

60 s

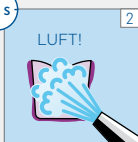

LUFT!

Präparation

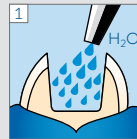

H₂O

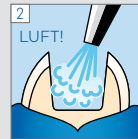

LUFT!

Total Etch:

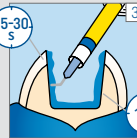

15-30 s

optional

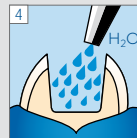

H₂O



LUFT!

Adhese Universal

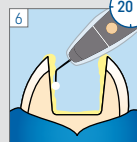

20 s



LUFT!

Pfützenbildung vermeiden

Bluephase G4

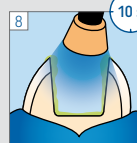

10 s

Befestigung

Variolink Esthetic LC

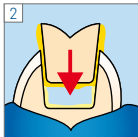
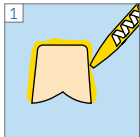

Bluephase G4



Restauration bis zum Ende der abschliessenden Polymerisation fixieren

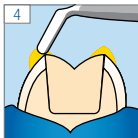

Liquid Strip

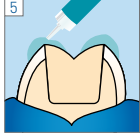
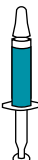

* pro Segment und mm Keramik

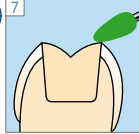

Polieren

Fluor Protector S

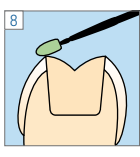

Hersteller
 Ivoclar Vivadent AG
 Beldererstrasse 2
 9494 Schaan/Liechtenstein
 www.ivoclar.com

CE 0123



See Instructions

Erstellungsdatum:
 2022-08-23
 666331/DE/Rev. 1



mehr Informationen unter
www.cementation-navigation.com

ivoclar